

Sharing an Avontus Viewer Model

Avontus Viewer enables you to easily share models with other users.

To share an Avontus Viewer model:

1. Log in to the Avontus Viewer desktop app.

The *Avontus Viewer* dialog appears.

2. Locate and click the name of the model you want to share.

The model appears in the window in the right-hand side of the dialog.

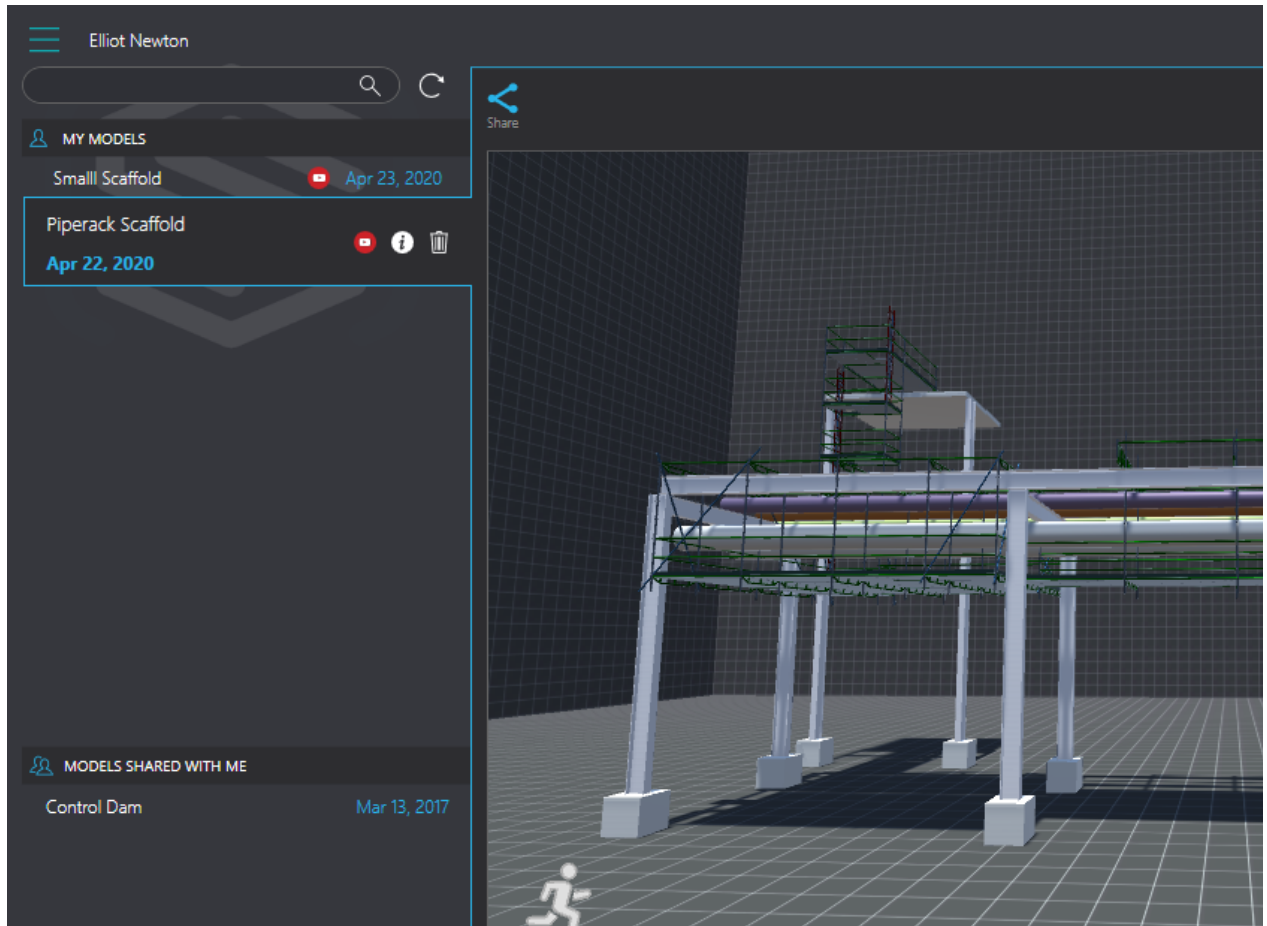

3. Click the **Share** icon () in the upper left-hand corner of the display window.

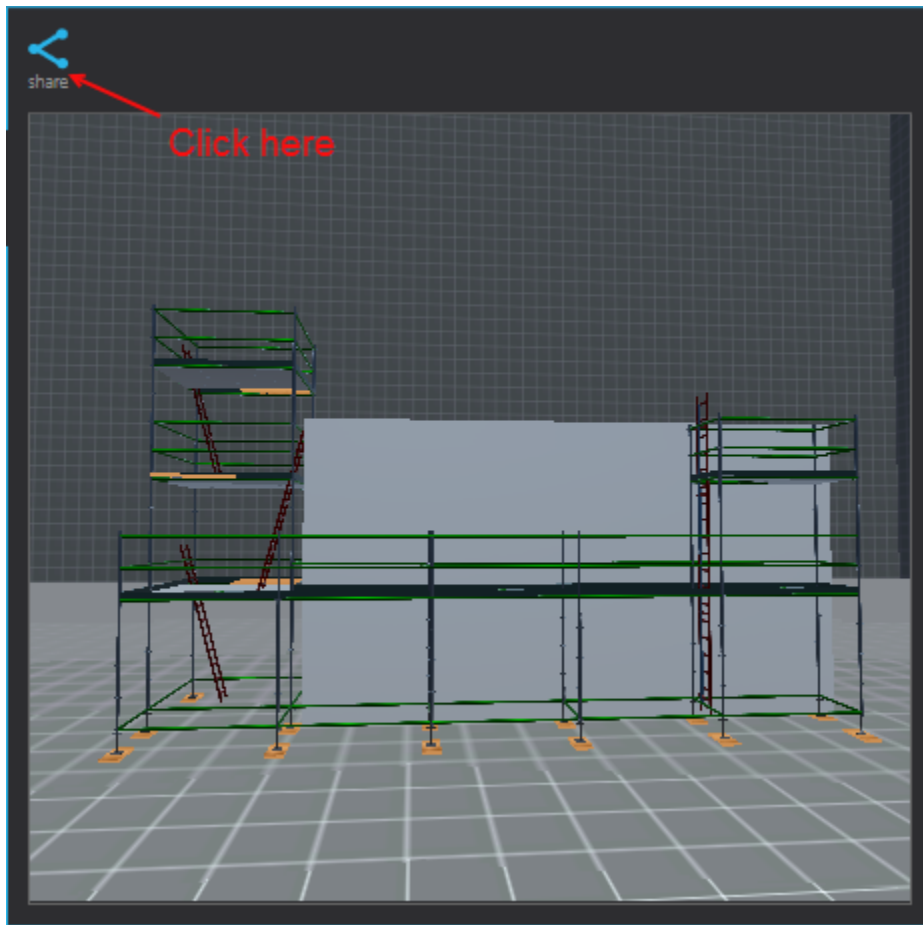

The *Share with Someone* dialog appears.

4. Click in the **Email Address** text field and enter the email address of the person with whom you want to share the model, then click the check in the bottom right-hand corner of the dialog.

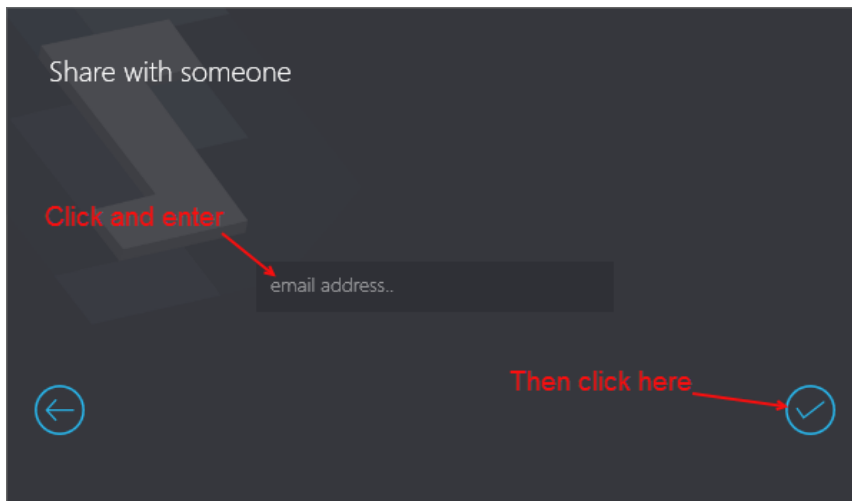

The *Avontus Viewer* dialog returns, displaying the name of the person with whom you shared the models the upper left-hand corner of the display window.

